

ATTACHMENT A Building Technical Specifications and Scope of Work

GENERAL SPECIFICATIONS:

- PROPOSALS SHALL INCLUDE ALL GENERAL CONDITIONS IN THE PRICE OF THE K9 KENNEL BUILDING. THE TRAINING BUILDINGS SHOULD REFLECT THE CONSTRUCTION COSTS OF THE BUILDINGS. ANY FURTHER EXPLANATION OR CLARIFICATION, IF NECESSARY, CAN BE PROVIDED IN YOUR COVER LETTER.
- PSO HAS SECURED A PRIVATE PROVIDER FOR INITIAL PLANS REVIEW. PROPOSERS CAN ELECT TO USE PSO'S PRIVATE PROVIDER OR SELECT A PRIVATE PROVIDER OF THEIR OWN. ALLOWANCE INDICATED SHALL COVER ALL PRIVATE PROVIDER SERVICES OUTSIDE OF THE INITIAL PLANS REVIEW.
- ALL CIVIL WILL BE COMPLETED OUTSIDE THIS PROJECT WITH THE EXCEPTION OF THE SIDEWALKS THAT RUN IN BETWEEN THE BUILDINGS. THE FRONT SIDE WALK THAT RUNS ALONG THE PARKING LOT AND PARKING LOT ITSELF ARE PART OF CIVIL SCOPE.
- FENCING FOR FIELD, AS OUTLINED IN CIVIL PLANS, WILL BE PROVIDED BY PSO AND IS NOT SUBJECT TO THIS RFP.
- GUTTERS AND DOWNSPOUTS ARE REQUIRED FOR ALL THREE BUILDINGS
- PHONE SYSTEM WILL BE PROVIDED AND MAINTAINED BY PASCO COUNTY
- IT EQUIPMENT SHOULD BE FURNISHED BY CONTRACTOR. PSO WILL CONFIGURE AND INSTALL IT SWITCHES.
- THE PRIMARY POWER SUPPLY/TRANSFORMER IS INSTALLED IN THE NORTHEAST CORNER OF THE SITE. APPROXIMATE LOCATION INDICATED BELOW.

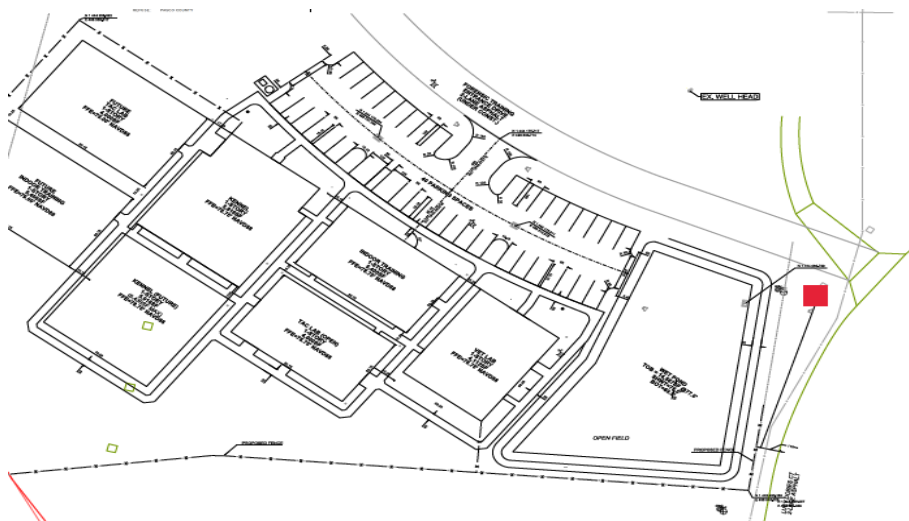

- NO FIRE ALARM SYSTEM IS REQUIRED.

- BUILDINGS REQUIRE SECURE ACCESS SYSTEMS AND SECURITY CAMERAS – COUNTY APPROVED VENDOR IS SKYNET. CONTACT DAVID WHITE DAVID@SKYNET-I.COM
- ALL METAL BUILDINGS INCLUDE THE METAL ROOF AS PART OF THE BUILDING PACKAGE. FOR THE KENNEL BUILDING ROOFING, PLEASE USE: MERCHANT + EVANS 2” ZIP-LOK STANDING SEAM PANEL ROOF 16” COVERAGE, 24 GAGE GALVANIZED COATED STEEL, SMOOTH TEXTURE FINISH. ALTERNATE ROOFING REQUIRES SUBMITTAL FOR APPROVAL.
- INSULATION SPECIFICATIONS FOR ROOF UNLESS OTHERWISE SPECIFIED IS R-30
- IF COLUMNS OF THE METAL BUILDINGS CONFLICT WITH STRUCTURAL SPECIFICATIONS (I.E. BATHROOMS), PLEASE PROVIDE THE METAL BUILDING MANUFACTURER AND STRUCTURAL LOCATIONS. WE WILL PROVIDE TO ARCHITECT/ENGINEER TO LOOK AT THE LOCATIONS OF THE COLUMNS AND RELOCATE ELEMENTS AS NEEDED.

BUILDING 1: K9 KENNEL

- CMU DESIGN
- APPROX. BUILDING WIDTH: 74’
- APPROX. BUILDING LENGTH: 90’
- BUILDING CONSTRUCTION SPECIFICATIONS IN COMPLIANCE WITH FLORIDA BUILDING CODE
- MODULAR KENNEL SYSTEM (24 KENNELS) – TWO VENDORS PSO HAS PREVIOUSLY CONTACTED ARE MASON KENNELS AND AEOLIS KENNELS.
- COSTS FOR DOG KENNELS ARE TO BE INCLUDED IN CONTRACTOR’S PROPOSAL. INSTALL IS PER WHICHEVER KENNEL MANUFACTURER IS CHOSEN BY CONTRACTOR. WE HAVE CALLED OUT TWO MANUFACTURERS; HOWEVER, THOSE ARE NOT REQUIRED. WE WANT TO MAKE SURE WHICHEVER VENDOR IS CHOSEN, THE MODULAR KENNEL SPECIFICATIONS ARE RATED FOR MILITARY OR LAW ENFORCEMENT WORKING DOGS. THE KENNELS SHOULD HAVE TOP COVERS TO PREVENT CLIMBING FROM ONE BAY TO THE NEXT. SOLID WALL PANELS THE ENTIRE HEIGHT WOULD BE PREFERRED. THE KENNELS DO NOT NEED FOOD AND WATER BOWLS.
- THE FENCING FOR KENNEL BUILDING SHOULD BE CONSTRUCTED OUT OF GALVANIZED STEEL FRAME WITH DURABLE 6 GAGE CHAIN LINK WIRE MESH. WE WOULD RECOMMEND NOT GOING OVER 9 GAGE WIRE MESH AS THIS CAN REDUCE THE LEVEL OF SECURITY (AND DURABILITY) FOR THE FACILITY.
- TWO INDIVIDUAL BATHROOMS WITH SHOWERS
- DOG WASH/GROOMING ROOM
- OFFICE AND STORAGE
- BUILDINGS REQUIRE SECURE ACCESS SYSTEMS AND SECURITY CAMERAS – COUNTY APPROVED VENDOR IS SKYNET.

- IT REQUIREMENTS

- NETWORK RACK EQUIPMENT WILL BE MOUNTED IN SPECIFIED LOCATION FOR IT/STORAGE EQUIPMENT.
- ALL WIRING AT EVERY END-POINT MUST TERMINATED AND LABELED AT THE GANG BOX FACE PLATE, COPPER PATCH PANELS AND FIBER LIU.
- CABLE TESTING ON ALL FIBER AND COPPER CABLING MUST BE COMPLETED AND RESULTS GIVEN TO PSO IT.
- EACH WALL IN OFFICE SHOULD HAVE 1 CAT6 DROP FOR DATA AND 1 CAT6 DROP FOR VOIP TELEPHONES. THE DATA DROP MUST USE A BLUE KEYSTONE AND THE VOIP DROP MUST USE A GREEN KEYSTONE.
- CAT6 CABLES NEED TO BE RAN IN CEILING TO SUPPORT WIRELESS ACCESS POINT CONNECTIONS.
- THE FOLLOWING LIST OF EQUIPMENT MUST BE USED MUST BE PROCURED FOR USE IN THIS BUILDING:

<u>Switches</u>	<u>Model numbers</u>	<u>Qty</u>
Model Number:		
Switch with MACSec	C9200L-48P-4G	1
Power Management:		
Optional secondary power supply	PWR-C5-1KWAC	1
Warranty services	SNT	1
<u>Access Points</u>		
Model Number:		
2800 Indoor AP	AIR-AP2802I-B-K9	3
<u>SFP Modules</u>		
(1Gbit) 1000BASE-LX/LH SFP	GLC-LH-SMD=	1
<u>Network Rack</u>	<u>Model numbers</u>	
Network rack	12 RU wall mountable network rack	1
Punch down panels	Cable Matters 48 port, 2 RU 180012-Cat6	2
Copper patch cables	Cable Matters Snagless Cat6 Blue Ethernet 5' Cable	25
Copper patch cables	Cable Matters Snagless Cat6 Blue Ethernet 7' Cable	25
Fiber patch cables	C2G 28758 OS2 Fiber Optic Cable - LC-LC 9/125 Duplex Single-Mode PVC Fiber Cable, Yellow (9.8 Feet, 3 Meters)	2
LIU tray	Corning LANscape Closet Connector Housing, Accepts 2 CCH Panels CCH-	1

	01U	
LIU fiber bulk head	CCH-CP12-A8	2
Power Management	Model numbers	
Power strips	EMAT08-10	1
Small rack mounted UPS can be used		1
Cabling requirements	Model numbers	
Terminate copper	CAT6	
Terminate copper at keystones	Tripp Lite brand (N042-001-04-WH), (N080-106) and (N238-025-BL)	
Terminate Fiber at each end of connection		

- **CORRECTIONS/CLARIFICATIONS OF DRAWINGS:**

- DOOR 108A IS NOT AN EGRESS DOOR. THIS IS JUST A STANDARD DOUBLE DOOR.
- THE HARDWARE FOR GROUP 4 WOULD BE: THREE HINGES, LEAVER STYLE DOOR HANDLE, WITH 24" KICKPLATE ON BOTH SIDES OF THE DOOR. DOOR 109A, 110A, 110 B, 111A, AND 111B WOULD BE IN HARDWARE GROUP #1.
- DOOR 101B SHOULD BE SOLID LIKE ALL OTHER DOORS. THERE WOULD BE NO GLASS LOCATED WITHIN THIS DOOR.
- TO CLARIFY SHEETS A1.1, A1.3, A4.0, AND A4.1, THERE ARE THREE COLUMNS LOCATED IN THE WALL. WHAT IS LOOKS LIKE COLUMNS AT THE END OF THE WALLS ARE IN FACT BLOCK WALLS WITH DOORS WITHIN THEM. THE FINISH FOR THE COLUMNS ARE TO BE STUCCO. PLEASE SEE WALL SECTION DETAIL 1/A5.1.
- LINTEL L-1 (A1.3) IS A TYPO AND SHOULD NOT HAVE BEEN INCLUDED ON THE SET. PLEASE DISREGARD LINTEL L-1.
- SHEET A1.2 WALL TYPES D AND E INDICATE WOOD FRAMING. PLEASE DISREGARD THIS NOTE. THIS IS A TYPO.
- THE MIDDLE WALL THAT SPLITS THE KENNELS INTO TWO BANKS SHOULD BE CMU AS SHOWN IN THE FOUNDATION PLAN PER A1.2 AND LINTEL PLAN PER A1.3, NOT WOOD FRAMED.
- THE "STUCCO WITH STONE FINISH" CALLED OUT ON K9 KENNEL IS JUST ROUGH STUCCO FINISH INSTEAD OF A SMOOTH STUCCO FINISH.

- **NOTE: BELOW GRAPHIC PROVIDED FOR CONCEPTUAL REFERENCE ONLY. SPECIFIC DETAILS IN ATTACHED CONSTRUCTION DOCUMENTS.**

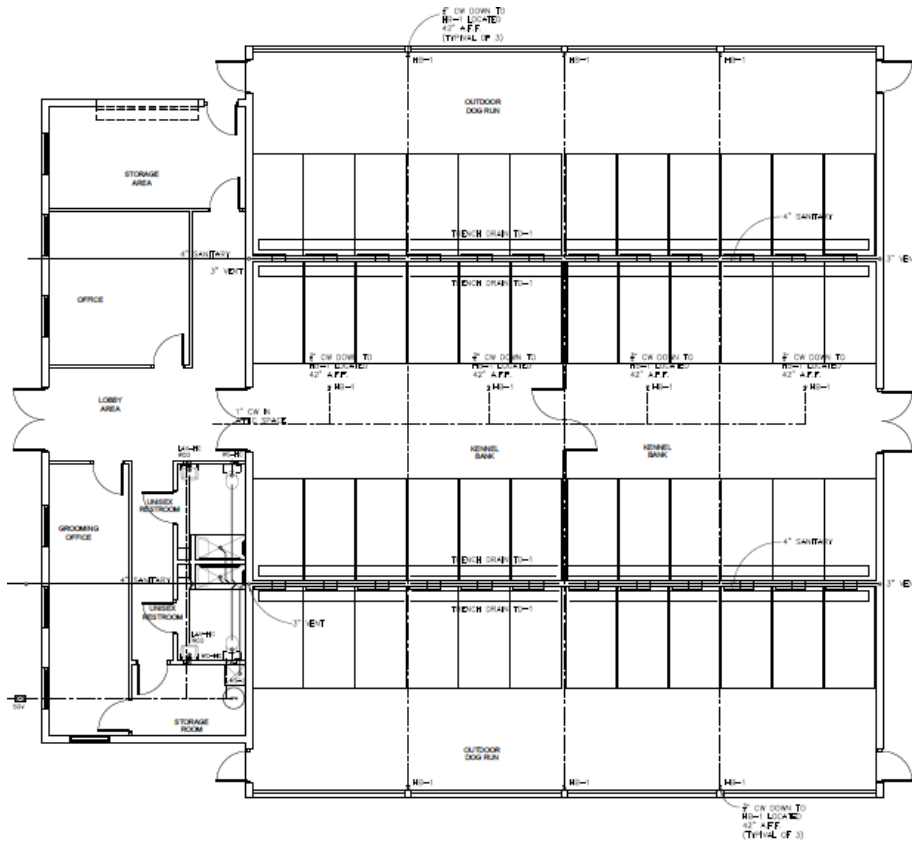

BUILDING 2: K9 OFFICES / CLASSROOM (JOINED TO BUILDING 2B BY BREEZEWAY)

- METAL BUILDING DESIGN
- APPROX. BUILDING WIDTH: 50'
- APPROX. BUILDING LENGTH: 80'
- BUILDING CONSTRUCTION SPECIFICATIONS IN COMPLIANCE WITH FLORIDA BUILDING CODE
- 26 GAUGE INSULATED METAL WALL PANELS TO BE 2" KINGSPAN OPTIMO PANELS (OR SIMILAR) WITH VERTICAL APPLICATION AND PREMIUM MICA FLOROPAN CLASSIC COLOR SELECTION.
- PARAPET WALLS AND HIGH SIDE 2" KINGSPAN OPTIMO PANELS (OR SIMILAR) SAME AS WALLS
- OFFICES, CONFERENCE ROOM, CLASSROOM, BATHROOMS, BREAKROOM.
- BUILDINGS REQUIRE SECURE ACCESS SYSTEMS AND SECURITY CAMERAS – COUNTY APPROVED VENDOR IS SKYNET
- IT REQUIREMENTS
 - NETWORK RACK EQUIPMENT WILL BE MOUNTED IN SPECIFIED LOCATION FOR IT/STORAGE EQUIPMENT.
 - THIS BUILDING WILL ACT AS A HUB LOCATION, CONNECTING THE KENNEL BUILDING BY A 12 STRAND BUNDLE OF FIBER.
 - ALL WIRING AT EVERY END-POINT MUST TERMINATED AND

LABELED AT THE GANG BOX FACE PLATE, COPPER PATCH PANELS AND FIBER LIU.

- CABLE TESTING ON ALL FIBER AND COPPER CABLING MUST BE COMPLETED AND RESULTS GIVEN TO PSO IT.
- WIRELESS ACCESS POINTS FROM BUILDING 3 MAY CONNECT TO BUILDING 2 BY CAT6 COPPER IF THE RUN IS LESS THAN 300 FEET, OTHERWISE FIBER CONNECTIONS MUST BE RAN TO THE ACCESS POINTS.
- EACH OFFICE AND CONFERENCE ROOM WALL SHOULD HAVE 1 CAT6 DROP FOR DATA AND 1 CAT6 DROP FOR VOIP TELEPHONES. THE DATA DROP MUST USE A BLUE KEYSTONE AND THE VOIP DROP MUST USE A GREEN KEYSTONE.
- CAT6 CABLES NEED TO BE RAN IN CEILING TO SUPPORT WIRELESS ACCESS POINT CONNECTIONS.
- THE FOLLOWING LIST OF EQUIPMENT MUST BE USED MUST BE PROCURED FOR USE IN THIS BUILDING:

Switches	Model numbers	Qty
Model Number:		
Switch with MACSec	C9200L-48P-4G	2
Stacking modules:		
Switch stacking kit	C9200L-STACK-KIT	2
Power Management:		
Optional secondary power supply	PWR-C5-1KWAC	2
Warranty services	SNT	2
Access Points		
Model Number:		
2800 Indoor AP	AIR-AP2802I-B-K9	3
SFP Modules		
(1Gbit) 1000BASE-LX/LH SFP	GLC-LH-SMD=	6
Network Rack	Model numbers	
Network rack	48 RU, 2 post rack Chatsworth Standard Rack 6"D (150 mm)	1
Network ladder	Chatsworth Quick Ship Cable Runway Kit	1
Cable management	Chatsworth Velocity [®] ™ Standard Pack (VSP)	1
Punch down panels	Cable Matters 48 port, 2 RU 180012-Cat6	2
Copper patch cables	Cable Matters Snagless Cat6 Blue Ethernet 5' Cable	50

Copper patch cables	Cable Matters Snagless Cat6 Blue Ethernet 7' Cable	50
Fiber patch cables	C2G 28758 OS2 Fiber Optic Cable - LC-LC 9/125 Duplex Single-Mode PVC Fiber Cable, Yellow (9.8 Feet, 3 Meters)	6
LIU tray	Corning LANscape Closet Connector Housing, Accepts 2 CCH Panels CCH-01U	1
LIU fiber bulk head	CCH-CP12-A8	2
Power Management	Model numbers	
Power strips	EMAT08-10	1
UPS	SRT1500XLA	1
Rail mounting kit	SRTRK4	1
Management	AP9631	1
Temperature sensor	AP9335TH	1
Network management	AP9630	1
Cabling requirements	Model numbers	
Terminate copper	CAT6	
Terminate copper at keystones	Tripp Lite brand (N042-001-04-WH), (N080-106) and (N238-025-BL)	
Terminate Fiber at each end of connection		

- **CORRECTIONS/CLARIFICATIONS OF CONSTRUCTION DOCUMENTS:**
 - PLEASE INCREASE THE BUILDING HEIGHT OF INDOOR TRAINING OFFICE SO THE LOW EAVE HEIGHT IS AT 11'-0" AS TO NOT CONFLICT WITH DESIGN SPECIFICATIONS.
 - SHOULD BE 4" THICK CONCRETE SLAB ON GRADE AS INDICATED IN FOUNDATION NOTE 1 ON SHEET A1.1, NOT 6".
 - DOOR 103A IS A SINGLE DOOR NOT A DOUBLE DOOR.
 - DOOR 107A WOULD BE SOLID GLASS. DOOR 117A WOULD HAVE NO GLASS WITHIN IT.

BUILDING 3: INDOOR K9 TRAINING FACILITY (JOINED TO BUILDING 2A BY BREEZEWAY)

- METAL BUILDING DESIGN
- APPROX. BUILDING WIDTH: 50'
- APPROX. BUILDING LENGTH: 80'

- BUILDING CONSTRUCTION SPECIFICATIONS IN COMPLIANCE WITH FLORIDA BUILDING CODE
- 26 GAUGE INSULATED METAL WALL PANELS TO BE 2” KINGSPAN OPTIMO PANELS (OR SIMILAR) WITH VERTICAL APPLICATION AND PREMIUM MICA FLOROPAN CLASSIC COLOR SELECTION.
- PARAPET WALLS AND HIGH SIDE 2” KINGSPAN OPTIMO PANELS (OR SIMILAR) SAME AS WALLS
- OPEN WAREHOUSE STYLE TRAINING AREA, STORAGE ROOM WITH OVERHEAD STORAGE ACCESS
- BUILDINGS REQUIRE SECURE ACCESS SYSTEMS AND SECURITY CAMERAS – COUNTY APPROVED VENDOR IS SKYNET
- IT REQUIREMENTS
 - ALL WIRING AT EVERY END-POINT MUST TERMINATED AND LABELED AT THE GANG BOX FACE PLATE, COPPER PATCH PANELS AND FIBER LIU.
 - WIRELESS ACCESS POINTS FROM BUILDING 3 MAY CONNECT TO BUILDING 2 BY CAT6 COPPER IF THE RUN IS LESS THAN 300 FEET, OTHERWISE FIBER CONNECTIONS MUST BE RAN TO THE ACCESS POINTS.
 - CABLE TESTING ON ALL FIBER AND COPPER CABLING MUST BE COMPLETED AND RESULTS GIVEN TO PSO IT.
 - CAT6 CABLES NEED TO BE RAN IN CEILING TO SUPPORT WIRELESS ACCESS POINT CONNECTIONS.
 - THE FOLLOWING LIST OF EQUIPMENT MUST BE USED MUST BE PROCURED FOR USE IN THIS BUILDING:

<u>Access Points</u>		
Model Number:		
2800 Indoor AP	AIR-AP2802I-B-K9	3
<u>SFP Modules</u>		
(1Gbit) 1000BASE-LX/LH SFP	GLC-LH-SMD=	6
<u>Cabling requirements</u>		<u>Model numbers</u>
Terminate copper	CAT6	
Terminate copper at keystone	Tripp Lite brand (N042-001-04-WH), (N080-106) and (N238-025-BL)	
Terminate Fiber at each end of connection		

- **NOTE: BELOW GRAPHIC PROVIDED FOR CONCEPTUAL REFERENCE ONLY. SPECIFIC DETAILS IN ATTACHED CONSTRUCTION DOCUMENTS.**

